

**GENERAL MEETING OF THE BOARD OF DIRECTORS  
OF THE NORTH EAST TEXAS  
REGIONAL MOBILITY AUTHORITY**

**RESOLUTION NO. 17-31**

WHEREAS, the North East Texas Regional Mobility Authority ("NET RMA") was created pursuant to the request of Gregg and Smith Counties and in accordance with provisions of the Transportation Code and the petition and approval process established in 43 Tex. Admin. Code § 26.1, *et seq.* (the "RMA Rules"); and

WHEREAS, the Board of Directors of the NET RMA has been constituted in accordance with the Transportation Code and the RMA Rules; and

WHEREAS, subsequent to the initial formation of the NET RMA the Counties of Cherokee, Rusk, Harrison, Upshur, Bowie, Panola, Titus, Van Zandt, Wood, and Kaufman joined the Authority and are represented on the Board of Directors; and

WHEREAS, the NET RMA is currently pursuing the development of Segment 4 of Toll 49 (the "Project"); and

WHEREAS, on March 1, 2016, in Resolution No. 16-21, the Board of Directors authorized the Interim Executive Director to enter into a contract (the "Agreement") for the construction of the Project with Webber, LLC ("Webber") in the amount of \$68,760,000.00; and

WHEREAS, on June 14, 2016, in Resolution No. 16-63, the NET RMA Board of Directors approved Change Order No. 1.0 to the Agreement with no financial impact; and

WHEREAS, on October 11, 2016, in Resolution No. 16-91, the NET RMA Board of Directors approved Change Order No. 2.0 to the Agreement for an amount not to exceed \$26,247.38; and

WHEREAS, on October 11, 2016, in Resolution No. 16-92, the NET RMA Board of Directors approved Change Order No. 3.0 to the Agreement for an amount not to exceed \$17,257.93; and

WHEREAS, on October 11, 2016, in Resolution No. 16-93, the NET RMA Board of Directors approved Change Order No. 4.0 to the Agreement for an amount not to exceed \$156,926.00; and

WHEREAS, on February 14, 2017, in Resolution No. 17-12, the NET RMA Board of Directors approved Change Order No. 5.0 to the Agreement for an amount not to exceed \$100,000.00; and

WHEREAS, NET RMA consultants have determined that various improvements and adjustments are needed on Segment 4 and recommend the ratification of Change Order Nos. 6.0, 7.0, and 8.0 to the Agreement, attached hereto as Attachment "A", for an amount not to exceed \$34,276.66 for Change Order No. 6.0, \$3,721.82 for Change Order No. 7.0, and \$4,231.40 for Change Order No. 8.0 to provide for such measures; and

WHEREAS, considering the Agreement, previously approved Change Orders Nos. 1.0 through 5.0, and proposed Change Order Nos. 6.0 through 8.0, the maximum amount to be paid for services under the Agreement is \$69,102,661.19; and

WHEREAS, the NET RMA Executive Director previously executed Change Order Nos. 6.0, 7.0, and 8.0; and

WHEREAS, it is appropriate for the NET RMA Board of Directors to ratify Change Order Nos. 6.0, 7.0, and 8.0; and

WHEREAS, the NET RMA general engineering consultant, RS&H, has represented to the Board of Directors that the work reflected in Change Order Nos. 6.0, 7.0, and 8.0 is necessary and appropriate.

NOW THEREFORE, BE IT RESOLVED, that the Board of Directors ratifies Change Order Nos. 6.0, 7.0, and 8.0 in the form or substantially the same form attached hereto as Attachment "A", for an amount not to exceed \$34,276.66 for Change Order No. 6.0, \$3,721.82 for Change Order No. 7.0, and \$4,231.40 for Change Order No. 8.0; and

BE IT FURTHER RESOLVED, that all work performed under Change Order Nos. 6.0, 7.0, and 8.0 shall be subject to the Agreement between the NET RMA and Webber and that no additional work may be undertaken without the specific approval of the Board of Directors.

Adopted by the Board of Directors of the North East Texas Regional Mobility Authority on the 13th day of June, 2017.

Submitted and reviewed by:

Approved:

  
\_\_\_\_\_  
C. Brian Cassidy  
General Counsel for the North East  
Texas Regional Mobility Authority

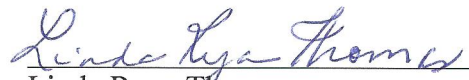
  
\_\_\_\_\_  
Linda Ryan Thomas  
Chair, Board of Directors  
Date Passed 6/13/17



TOLL 49 SEGMENT 4 IMPROVEMENTS PROJECT



CHANGE ORDER NO. 6

Project Information									
Project Name	Toll 49 Segment 4 Improvements								
CSJ	3487-01-017, 3487-01-018								
Owner	North East Texas Regional Mobility Authority (NET RMA)								
Description and Reason for the Change Order									
<p>This change order is necessary to incorporate the cost of additional cast-in-place retaining wall required to complete retaining wall #4. The elevation at the bottom of the footing for the retaining wall as originally shown on plan sheet 471 was above the in situ invert elevation of stream 13. To prevent the wall from being undermined in a heavy stream flow, the top of the footing for the portion of wall located along the stream bank was lowered 1 LF below the existing stream channel. Lowering the bottom of the wall and leaving the top unchanged increased the overall wall height and required width at the base; thus, additional reinforcement steel and concrete were required to satisfy minimum design standards.</p>									
Price & Budget									
<p>Webber's price proposal attached includes the cost of additional excavation, reinforcement steel, concrete, and labor required to complete the work. NET RMA has reviewed the proposal and it appears the costs are reasonable and recommends approval. The work associated with this change order will increase the Contract Value by a lump sum amount of \$34,276.66.</p> <table><tbody><tr><td>Original Bid Amount:</td><td>\$ 68,760,000.00</td></tr><tr><td>Previously Approved Change Orders:</td><td>\$ 300,431.31</td></tr><tr><td>Change Order 6 Amount:</td><td>\$ 34,276.66</td></tr><tr><td>Contract Max Not to Exceed Amount:</td><td>\$ 69,094,707.97</td></tr></tbody></table> <p><b>This amount will not be exceeded without prior authorization from the NET RMA.</b></p>		Original Bid Amount:	\$ 68,760,000.00	Previously Approved Change Orders:	\$ 300,431.31	Change Order 6 Amount:	\$ 34,276.66	Contract Max Not to Exceed Amount:	\$ 69,094,707.97
Original Bid Amount:	\$ 68,760,000.00								
Previously Approved Change Orders:	\$ 300,431.31								
Change Order 6 Amount:	\$ 34,276.66								
Contract Max Not to Exceed Amount:	\$ 69,094,707.97								
Project Schedule									
Adjustment to Schedule	No change								



TOLL 49 SEGMENT 4 IMPROVEMENTS PROJECT

CHANGE ORDER NO. 6

Signatures	
<p>ACCEPTED:</p> <p>Webber, LLC</p>	<p>Signature: </p> <p><del>Todd Jackson</del>, Vice President - <del>Estimating</del></p> <p><u>JOSH GOYNE</u> NORTH TEXAS</p> <p>Date: <u>4/17/2017</u></p>
<p>APPROVED:</p> <p>NET RMA</p>	<p>Signature: </p> <p>Chris Miller, Executive Director</p> <p>Date: <u>4/19/2017</u></p>



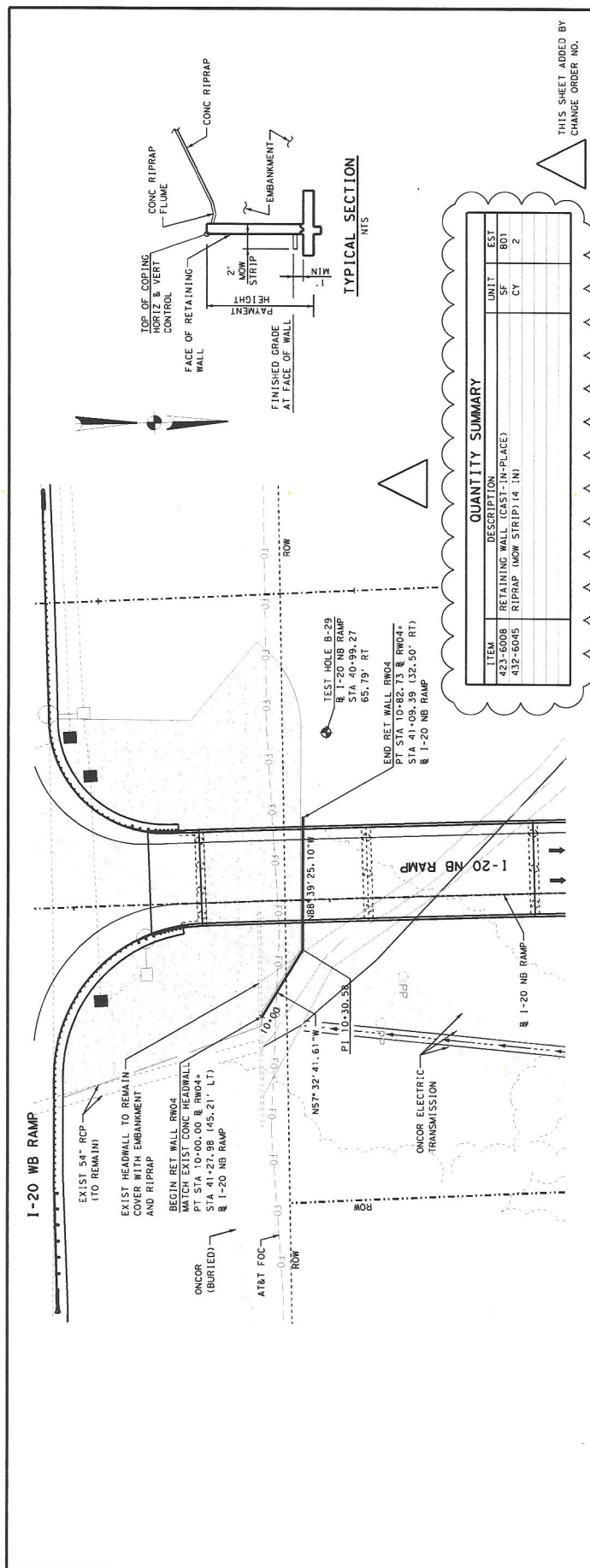

QUANTITY SUMMARY			
ITEM	DESCRIPTION	UNIT	EST
423-6008	RETAINING WALL (CAST-IN-PLACE)	SF	801
432-6045	RIPRAP (NOW STRIP) (4 IN)	CY	2

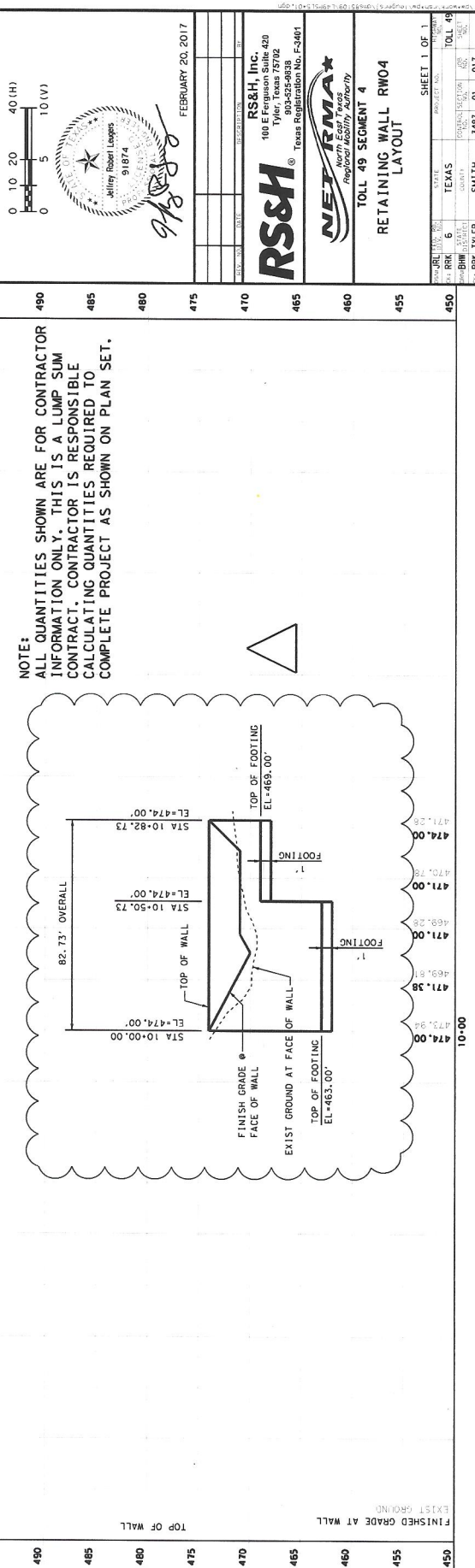

FEBRUARY 20, 2017

**RS&H**<sup>®</sup>  
**RS&H, Inc.**  
 100 E Ferguson Suite 420  
 Tyler, Texas 75702  
 903-525-9838  
 Texas Registration No. F-3401



**TOLL 49 SEGMENT 4**  
**RETAINING WALL RW04**  
**LAYOUT**

STATE	JUL 1975	PL	STATE	PROJECT NO.	SHEET NO.	
TX	6		TEXAS		TOLL 45	1
El: RRK			COUNTY	CONTROL	SEC	POS
BHW			DISTRICT			NO.
BOV				2407	01	017
DOV						

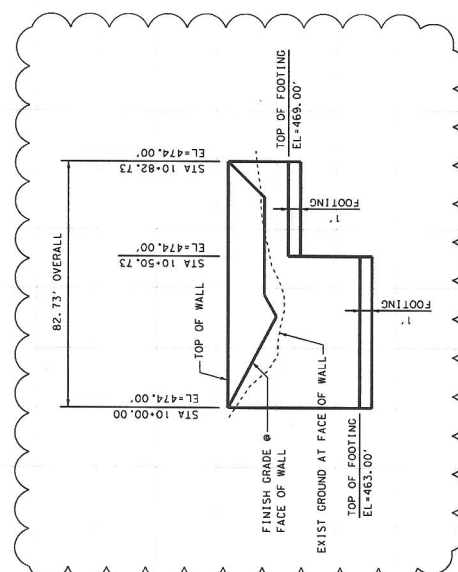



**North Texas Region**  
1900 Westridge Drive  
Suite 100  
Irving, TX 75038

March 15, 2017

Mark W. Hirsch, PE  
Vice President  
RS&H, Inc.  
15660 N Dallas Pkwy  
Suite 220  
Dallas, TX 75248

WWV-030

Control: 3487-01-017 & 3487-01-018  
Highway: Toll 49 Segment 4  
County: Smith

Re: Retaining Wall #4 – Stop Work

Mr. Hirsch,

Please find under cover of this letter a change order request for work done before Webber was directed to stop work at Retaining Wall #4 and the cost to complete the Retaining Wall #4 according to the new sheets issued on 2/20/2017. This price does not include the additional excavation and potholing required as Webber requests this work to be done under Force Account. The cost of this change order excluding the force account work is \$34,276.66.

Please review the attached cost breakdowns with associated backup and provide a change order for our review and execution so Webber can proceed with the construction of Retaining Wall #4.

If you have any questions or require any additional information please feel free to contact me at 469-446-7799.

Respectfully,

Matt Anderson  
Project Engineer

Cc: Jason Eiland – Webber, Project Manager



# **Cast-In-Place Retaining Wall #4 - Stop Work & Redesign**

**COR-019**

TOLL 49 SEGMENT 4  
CONTROL: 3487-01-017 & 3487-01-018  
COUNTY: SMITH  
HIGHWAY: TOLL 49

LABOR					
DESCRIPTION	QTY	TASK	UNIT	LS	AMT
Operator	1	Excavating	4	\$ 17.50	\$ 70.00
					\$ -
					\$ -
					\$ -
					\$ -
					\$ -
					\$ -
TOTAL LABOR COST					\$ 70.00
25% LABOR MARKUP					\$ 17.50
55% LABOR BURDEN					\$ 38.50
SUBTOTAL					\$ 126.00
1% BOND					\$ 1.26
LABOR TOTAL					\$ 127.26

EQUIPMENT					
DESCRIPTION	QTY	TASK	UNIT	LS	AMT
Backhoe 310	1	Excavating	4	\$ 32.12	\$ 128.48
					\$ -
					\$ -
					\$ -
					\$ -
TOTAL EQUIPMENT COST					\$ 128.48
15% EQUIPMENT MARKUP					\$ 19.27
SUBTOTAL					\$ 147.75
1% BOND					\$ 1.48
EQUIPMENT TOTAL					\$ 149.23

MATERIALS					
DESCRIPTION	QTY	UNIT	RATE	AMT	
Rebar - Orginal Design	3,436	LBS	\$ 0.27	\$ 927.72	
Rebar - New Design	9,698	LBS	\$ 0.27	\$ 2,618.46	
Concrete - Additional needed for New Design	26	CY	\$ 123.67	\$ 3,237.68	
				\$ -	
				\$ -	
				\$ -	
				\$ -	
				\$ -	
TOTAL MATERIAL COST					\$ 6,783.86
25% MATERIAL MARKUP					\$ 1,695.97
SUBTOTAL					\$ 8,479.83
1% BOND					\$ 84.80
MATERIAL TOTAL					\$ 8,564.62

SUBCONTRACTORS					
DESCRIPTION	QTY	UNIT	RATE	AMT	
Indus - Revised Design	801	SF	\$ 36.17	\$ 28,973.44	
Indus - Original Design	-496	SF	\$ 21.50	\$ (10,664.00)	
Indus - Before Stop Work	42	HRS	\$ 40.00	\$ 1,680.00	
MCL - Revised Design	9,698	LBS	\$ 0.32	\$ 3,070.39	
MCL - Before Stop Work	2,921	LBS	\$ 0.32	\$ 924.66	
				\$ -	
TOTAL SUBCONTRACTOR COST					\$ 23,984.49
5% SUBCONTRACTOR MARKUP					\$ 1,199.22
SUBTOTAL					\$ 25,183.71
1% BOND					\$ 251.84
SUBCONTRACTOR TOTAL					\$ 25,435.55

**TOTAL COST** **\$ 34,276.66**



INDUS Road & Bridge. 11143, Suite B, Goodnight Lane,  
Dallas, Texas 75229 Phone: 972-241-1756

Foreman's Daily Time & Material Sheet  
Tiempo Diario y Material Hoja de Foreman

DATE/FECHA:

2/19/17

TIME/HORA:

7 am

Contractor/Contratista

Hwy/Carretera

County/Condado

Location/Localizacion

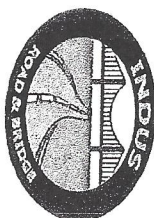

Employee Name/ Nombre de Empleado	Labor Hours/Horas Laborales	Equipment used/Equipamiento usado	Equipment Hrs/ hora Equipos
1- Eugenio Perez	6 hours		
2- Luis Rodriguez	6 hours		
3- Ismael Rodriguez	8 hours		
4- Adrian Silva	8 hours		
5- Luis Morales	2 hours		
6- Jose Rodriguez	2 hours		
7-			
8-			
9-			
10-			
11-			
TOTAL HOURS/ HORAS TOTALES	32 hours		

Material used/ Material utilizado	Quantity/Cantidad
Description of work/ descripcion de trabajo We went to look for wooden shapers and bars and pieces of wood and we started to form the furing and it was 100% forged as well a furing with a shovel and with the shovel ready	

GENERAL CONTRACTOR APPROVAL/ APROBACION CONTRATISTA GENERAL	
Name: Mr. Anderson	
Signature:	
Firma	
Foreman Name/Nombre:	Eugenio Perez
Comments/Comentarios:	

INDUS Road & Bridge. 11143, Suite B, Goodnight Lane,  
Dallas, Texas 75229 Phone: 972-241-1756

Foreman's Daily Time & Material Sheet  
Tiempo Diario y Material Hoja de Foreman

DATE/FECHA: 2/10/17 TIME/HORA: 7:00am-12:00pm

Contractor/Contratista \_\_\_\_\_ Hwy/Carretera \_\_\_\_\_ County/Condado \_\_\_\_\_ Location/Localizacion \_\_\_\_\_

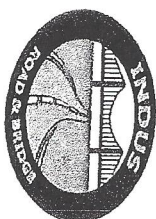

Employee Name/ Nombre de Empleado	Labor Hours/Horas Laborales	Equipment used/ Equipamiento usado	Equipment Hrs/ hora Equipos
1- Ismael Rodriguez	5 hours		
2- Adrian Silva	5 hours		
3-			
4-			
5-			
6-			
7-			
8-			
9-			
10-			
11-			
TOTAL HOURS/ HORAS TOTALES			

Material used/ Material utilizado	Quantity/ Cantidad
snag ties & braces and new installation	10 hours
Description of work/ descripcion de trabajo Foreman (Cristian) Design change for Owner Rep (Mike Cody) on 2/10/17.	

GENERAL CONTRACTOR APPROVAL/ APROBACION CONTRATISTA GENERAL	
Name/ Nombre	Man Anderson
Signature:	
Firma	
Foreman Name/ Nombre:	Eugene Doe
Comments/ Comentarios:	





webber

**CIP Wall RW04**

Change order number 1

TOLL 49 SEGMENT 4

COUNTY: SMITH

HIGHWAY: TOLL 49

LABOR					
DESCRIPTION	QTY	TASK	UOM(HRS)	Unit Rate	Total
<b>CIP WALL /Footing</b>					
FOREMAN	1	supervisor on workers	30	\$ 32.50	\$ 975.00
LABORERS	4	Check the grade,Set the form & Pour concrete	30	\$ 18.00	\$ 2,160.00
OPERATORS	1	Operate Sky truck,help in forming the footing & pour	30	\$ 18.00	\$ 540.00
<b>CIP WALL / Wall Panel</b>					
FOREMAN	1	supervisor on workers	50	\$ 32.50	\$ 1,625.00
LABORERS	4	Check the grade,Set the form & Pour concrete	50	\$ 18.00	\$ 3,600.00
OPERATORS	1	Operate Sky truck,help in forming the footing & pour	50	\$ 18.00	\$ 900.00
<b>CIP WALL / Rub &amp; Patch</b>					
FOREMAN	1	supervisor on workers	15	\$ 32.50	\$ 487.50
LABORERS	4	Rub & Patch the wall surface	15	\$ 18.00	\$ 1,080.00
OPERATORS	1	Rub & Patch the wall surface	15	\$ 18.00	\$ 270.00
<b>per diem</b>					
FOREMAN	1	per diem	80	\$ 5.00	\$ 400.00
LABORERS	4	per diem	80	\$ 3.77	\$ 1,205.44
OPERATORS	1	per diem	80	\$ 3.77	\$ 301.36
<b>TOTAL LABOR COST</b>					\$ 13,544.30
25% LABOR MARKUP					\$ 3,386.08
30% LABOR BURDEN					\$ 4,063.29
<b>SUBTOTAL</b>					\$ 20,993.67
<b>TOTAL LABOR COST</b>					\$ 20,993.67

EQUIPMENT					
DESCRIPTION	QTY	TASK	UOM(HRS)	Unit Rate	Total
<b>CIP WALL /Footing</b>					
Forklift	1	INSTALL FORMS ,HOLD THE CONCRETE BUCKET FOR POUR	20	\$ 55.61	\$ 1,112.20
<b>CIP WALL / Wall Panel</b>					
Forklift	1	INSTALL FORMS , MOVE THE CONCRETE BUCKET	40	\$ 55.61	\$ 2,224.40
Man-Lift	1	Transport worker,material,tools to do the job	40	\$ 45.33	\$ 1,813.20
<b>Truck allowance</b>					
Foreman Pickup	1	Transportation	80	\$ 16.25	\$ 1,300.00
<b>TOTAL EQUIPMENT COST</b>					\$ 6,449.80
15% EQUIPMENT MARKUP					\$ 967.47
<b>SUBTOTAL</b>					\$ 7,417.27
<b>EQUIPMENT TOTAL COST</b>					\$ 7,417.27

MATERIALS				
DESCRIPTION	QTY	UNIT	Unit Rate	Total
Nails	1	LS	\$ 250.00	\$ 250.00
Rub & Patch Material	1	LS	\$ 200.00	\$ 200.00
<b>TOTAL MATERIAL COST</b>				\$ 450.00
25% MATERIAL MARKUP				\$ 112.50
<b>SUBTOTAL</b>				\$ 562.50
<b>MATERIAL TOTAL COST</b>				\$ 562.50

<b>TOTAL COST</b>				\$ 28,973.44
-------------------	--	--	--	--------------



**Rental Rate Blue Book®**

March 15, 2017

**Deere 310J (disc. 2012)**

Tractor-Loader-Backhoes

Size Class:

14' to Under 15'

Weight:

14,360 lbs.

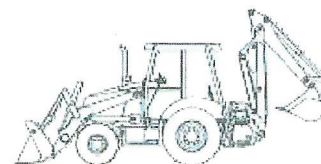
**Configuration for 310J (disc. 2012)**

Drive	4WD	Net Horsepower	84 hp
Power Mode	Diesel	Operator Protection	ROPS
Loader Bucket Capacity--Heaped	1 cu yd	Backhoe Stick	Fixed

**Blue Book Rates**

\*\* FHWA Rate is equal to the monthly ownership cost divided by 176 plus the hourly estimated operating cost.

	Ownership Costs				Estimated Operating Costs	FHWA Rate**
	Monthly	Weekly	Daily	Hourly	Hourly	Hourly
Published Rates	\$2,905.00	\$815.00	\$205.00	\$31.00	\$17.45	\$33.96
<b>Adjustments</b>						
Region (Texas: 88.9%)	(\$322.46)	(\$90.47)	(\$22.76)	(\$3.44)		
Model Year (2012: 100%)	-	-	-	-		
Ownership (100%)	-	-	-	-		
Operating (100%)	-	-	-	-		
<b>Total:</b>	<b>\$2,582.54</b>	<b>\$724.53</b>	<b>\$182.24</b>	<b>\$27.56</b>	<b>\$17.45</b>	<b>\$32.12</b>

**Rate Element Allocation**

Element	Percentage	Value
Depreciation (ownership)	33%	\$958.65/mo
Overhaul (ownership)	49%	\$1,423.45/mo
CFC (ownership)	7%	\$203.35/mo
Indirect (ownership)	11%	\$319.55/mo
Fuel (operating) @ 2.36	44%	\$7.71/hr

Revised Date: 2nd Half 2016

The equipment represented in this report has been exclusively prepared for WILLIAM WHITNEY (bill.whitney@webber.com)



www.equipmentwatch.com

All prices shown in US\$

## Rental Rate Blue Book®

March 2, 2017

### JLG 600SJ (disc. 2010)

L.C. Self Propelled Telescopic Boom Aerial Lifts



Size Class:

51 - 60 ft

Weight:

23,900 lbs.

### Configuration for 600SJ (disc. 2010)

Maximum Platform Height	725 in	Maximum Platform Capacity	500 lbs
Power Mode	Diesel	Horsepower	49
Drive	4WD		

### Blue Book Rates

\*\* FHWA Rate is equal to the monthly ownership cost divided by 176 plus the hourly estimated operating cost.

	Ownership Costs				Estimated Operating Costs	FHWA Rate**
	Monthly	Weekly	Daily	Hourly	Hourly	Hourly
Published Rates	\$5,675.00	\$1,590.00	\$400.00	\$60.00	\$16.50	\$48.74
Adjustments						
Region (Texas: 89.4%)	(\$601.55)	(\$168.54)	(\$42.40)	(\$6.36)		
Model Year (2010: 100%)	-	-	-	-		
Ownership (100%)	-	-	-	-		
Operating (100%)					-	
Total:	\$5,073.45	\$1,421.46	\$357.60	\$53.64	\$16.50	\$45.33

### Rate Element Allocation

Element	Percentage	Value
Depreciation (ownership)	38%	\$2,156.50/mo
Overhaul (ownership)	53%	\$3,007.75/mo
CFC (ownership)	3%	\$170.25/mo
Indirect (ownership)	6%	\$340.50/mo
Fuel (operating) @ 2.3	18%	\$2.98/hr

Revised Date: 1st Half 2017

The equipment represented in this report has been exclusively prepared for WILLIAM WHITNEY (bill.whitney@wwebber.com)



www.equipmentwatch.com

All prices shown in US\$

## Rental Rate Blue Book®

March 2, 2017

### JLG G10-55A (disc. 2017)

Telescoping Boom Rough Terrain Lift Trucks

Size Class:

4.5 - 4.9 MTons

Weight:

34,400 lbs.

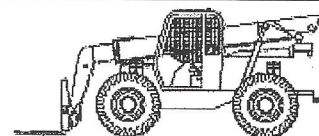

### Configuration for G10-55A (disc. 2017)

Horsepower	130 hp	Power Mode	Diesel
Base Capacity	10000 lbs	Maximum Reach	504 in
Maximum Lift Height	660 in		

### Blue Book Rates

\*\* FHWA Rate is equal to the monthly ownership cost divided by 176 plus the hourly estimated operating cost.

	Ownership Costs				Estimated Operating Costs	FHWA Rate**
	Monthly	Weekly	Daily	Hourly	Hourly	Hourly
Published Rates	\$5,555.00	\$1,555.00	\$390.00	\$59.00	\$26.70	\$58.26
Adjustments						
Region (Texas: 91.6%)	(\$466.62)	(\$130.62)	(\$32.76)	(\$4.96)		
Model Year (2017: 100%)	-	-	-	-		
Ownership (100%)	-	-	-	-		
Operating (100%)					-	
Total:	\$5,088.38	\$1,424.38	\$357.24	\$54.04	\$26.70	\$55.61

### Rate Element Allocation

Element	Percentage	Value
Depreciation (ownership)	30%	\$1,666.50/mo
Overhaul (ownership)	59%	\$3,277.45/mo
CFC (ownership)	3%	\$166.65/mo
Indirect (ownership)	8%	\$444.40/mo
Fuel (operating) @ 2.3	31%	\$8.40/hr

Revised Date: 1st Half 2017

The equipment represented in this report has been exclusively prepared for WILLIAM WHITNEY (bill.whitney@wwebber.com)



# Verify List - Bending

Page: 1 of 1

Job ID: 05516030  
Dwg: RW04  
Cust: Webber LLC

Job: Smith Toll 49 Structures 3847-  
Desc: HC-12-18.73 - WALL RW04

Ctrl Code: NLF  
Release: 220  
Dwg Ref: HC-12-18.73

M	Size	Shp	Length	Bar Mark	A	B	C	D	E	F/R	G	H	J	K	O	Pin	V	End Prep	BCD
D	7	17	6-11	A3		3-02	3-09												H04
D	6	17	8-10	A2		2-01	6-09												H04
D	5	17	13-03	A1		3-02	10-01												H03
D	5	17	2-06	B		0-06	2-00												C03
D	5	4	8-06	U	4-00	0-06	4-00					4-00		0-002					C06

# Verify List - Takeoff

Page 1 of 1

Job ID: 05516030  
Dwg: RW04  
Cust: Webber LLC

Job: Smith Toll 49 Structures 3847-  
Desc: HC-12-18.73 - WALL RW04

Ctrl Code: NLF  
Release: 220  
Dwg Ref: HC-12-18.73

Line	M	Qty	Mult1	Mult2	Size	Grd	Ctg	Length	Bar Mark	Lbs	V	Inc	No Ea	V Lgth 2	End Prep	Plan	Section
0		WEBBER LLC SMITH COUNTY TOLL ROAD 49 - SEGMENT 4															
1	4T	Desc: Dwg: Ref: ICC: Y Y Y															
7M		REINF.FOR RETAINING WALL RW04.....MODIFIED FROM ORIGINAL															
7M		DESIGN....."NEW" DESIGN = HC-12-18.73.															
7M		DETAILED FROM RETAINING WALL DESIGN RW 1(H)C - SHEET 475.															
2	6R	16	1		5	60	B		A1	221							
3	6R	15	1		6	60	B		A2	199							
4	6R	15	1		7	60	B		A3	212							
5	6R	16	1		5	60	B		B	42							
6	6R	16	1		5	60	B	9-01	B1	152							
7	6R	24	1		9	60	B	5-09	C	469							
8	6R	24	1		5	60	B	18-03	D	457							
9	6R	8	1		8	60	B	3-00	F	64							
10	6R	6	1		5	60	B	18-03	H	114							
11	6R	4	1		5	60	B	18-03	T	76							
12	6R	16	1		5	60	B		U	142							

Total Weight

2,148 Lbs

# Verify List - Bending

Page: 1 of 1

Job ID: 05516030  
Dwg: RW04  
Cust: Webber LLC

Job: Smith Toll 49 Structures 3847-  
Desc: HC-12-32 - WALL RW04

Ctrl Code: NLD  
Release: 219  
Dwg Ref: HC-12-32

M	Size	Shp	Length	Bar Mark	A	B	C	D	E	F/R	G	H	J	K	O	Pin	V	End Prep	BCD
D	7	17	6-11	A3		3-02	3-09												H04
D	6	17	8-10	A2		2-01	6-09												H04
D	5	17	13-03	A1		3-02	10-01												H03
D	5	17	2-06	B		0-06	2-00												C03
D	5	4	6-00	CORNER		3-00	3-00					0-091		2-103					C
D	5	4	8-06	U	4-00	0-06	4-00					4-00		0-002					C06



# Verify List - Takeoff

Page 1 of 1

Job ID: 05516030  
Dwg: RW04  
Cust: Webber LLC

Job: Smith Toll 49 Structures 3847-  
Desc: HC-12-32 - WALL RW04

Ctrl Code: NLD  
Release: 219  
Dwg Ref: HC-12-32

Line	M	Qty	Mult1	Mult2	Size	Grd	Ctg	Length	Bar Mark	Lbs	V	Inc	No Ea	V Lgth 2	End Prep	Plan	Section
0		WEBBER LLC SMITH COUNTY TOLL ROAD 49 - SEGMENT 4															
1	4T	Desc: Dwg: Ref: ICC: Y Y Y															
7M		REINF.FOR RETAINING WALL RW04.....MODIFIED FROM ORIGINAL															
7M		DESIGN....."NEW" DESIGN = HC-12-32.															
7M		DETAILED FROM RETAINING WALL DESIGN RW 1(H)C - SHEET 475.															
2	6R	26	1		5	60	B		A1	359							
3	6R	25	1		6	60	B		A2	332							
4	6R	25	1		7	60	B		A3	354							
5	6R	26	1		5	60	B		B	68							
6	6R	26	1		5	60	B	9-01	B1	246							
7	6R	38	1		9	60	B	5-09	C	743							
8	6R	24	1		5	60	B	31-06	D	789							
9	6R	14	1		8	60	B	3-00	F	112							
10	6R	6	1		5	60	B	31-06	H	197							
11	6R	4	1		5	60	B	31-06	T	131							
12	6R	26	1		5	60	B		U	231							
13	7P	CORNER BARS FOR BEND @ STATION 10+30.58.															
14	6R	34	1		5	60	B		CORNER	213							

Total Weight

3,775 Lbs





TOLL 49 SEGMENT 4 IMPROVEMENTS PROJECT

CHANGE ORDER NO. 7

Project Information									
Project Name	Toll 49 Segment 4 Improvements								
CSJ	3487-01-017, 3487-01-018								
Owner	North East Texas Regional Mobility Authority (NET RMA)								
Description and Reason for the Change Order									
<p>This change order is necessary to incorporate the cost to adjust the 60" Reinforced Concrete Pipe (RCP) over the conflicting MHM gas line located approximately at station 355+00. Both the RCP and relocated gas line were installed to plan, but due to a skew in the design the CD-15 culvert and MHM gas line come into contact near the west end of the culvert. It was suggested by RS&amp;H to add concrete collars to the RCP in order to mitigate over the gas line to provide adequate clearance between both the culvert pipe and gas line while maintaining desired slope for proper drainage.</p>									
Price & Budget									
<p>NET RMA has reviewed the proposal and it appears the costs are reasonable and recommends approval. The work associated with this change order will increase the Contract Value by a lump sum amount of <b>\$3,721.82</b>.</p> <table><tbody><tr><td>Original Bid Amount:</td><td>\$ 68,760,000.00</td></tr><tr><td>Previously Approved Change Orders:</td><td>\$ 334,707.97</td></tr><tr><td>Change Order 7 Amount:</td><td>\$ 3,721.82</td></tr><tr><td>Contract Max Not to Exceed Amount:</td><td>\$ 69,098,429.79</td></tr></tbody></table> <p><b>This amount will not be exceeded without prior authorization from the NET RMA.</b></p>		Original Bid Amount:	\$ 68,760,000.00	Previously Approved Change Orders:	\$ 334,707.97	Change Order 7 Amount:	\$ 3,721.82	Contract Max Not to Exceed Amount:	\$ 69,098,429.79
Original Bid Amount:	\$ 68,760,000.00								
Previously Approved Change Orders:	\$ 334,707.97								
Change Order 7 Amount:	\$ 3,721.82								
Contract Max Not to Exceed Amount:	\$ 69,098,429.79								
Project Schedule									
Adjustment to Schedule	No change								

TOLL 49 SEGMENT 4 IMPROVEMENTS PROJECT

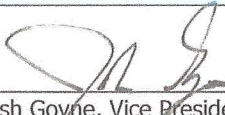

CHANGE ORDER NO. 7

Signatures	
ACCEPTED:  Webber, LLC	Signature:  Josh Goyne, Vice President – North Texas  Date: <u>5/16/2017</u>
APPROVED:  NET RMA	Signature:  Chris Miller, Executive Director  Date: <u>6-13-17</u>

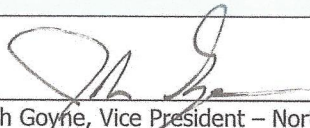

TOLL 49 SEGMENT 4 IMPROVEMENTS PROJECT

CHANGE ORDER NO. 8

Project Information									
Project Name	Toll 49 Segment 4 Improvements								
CSJ	3487-01-017, 3487-01-018								
Owner	North East Texas Regional Mobility Authority (NET RMA)								
Description and Reason for the Change Order									
<p>This change order is necessary to compensate the contractor for the relocation 6 additional water meters not shown in the plans along FM 16 that were discovered in the field upon the installation of new water main for the City of Lindale. These services must be relocated and connected the new water main in order to continue water service to existing City of Lindale customers.</p>									
Price & Budget									
<p>Webber's price proposal attached for additional meter relocates along FM16. The work associated with this change order will increase the Contract Value by a lump sum amount of <b>\$4,231.40</b>.</p> <table><tbody><tr><td>Original Bid Amount:</td><td>\$ 68,760,000.00</td></tr><tr><td>Previously Approved Change Orders:</td><td>\$ 338,429.79</td></tr><tr><td><u>Change Order 8 Amount:</u></td><td><u>\$ 4,231.40</u></td></tr><tr><td>Contract Max Not to Exceed Amount:</td><td>\$ 69,102,661.19</td></tr></tbody></table> <p><b>This amount will not be exceeded without prior authorization from the NET RMA.</b></p>		Original Bid Amount:	\$ 68,760,000.00	Previously Approved Change Orders:	\$ 338,429.79	<u>Change Order 8 Amount:</u>	<u>\$ 4,231.40</u>	Contract Max Not to Exceed Amount:	\$ 69,102,661.19
Original Bid Amount:	\$ 68,760,000.00								
Previously Approved Change Orders:	\$ 338,429.79								
<u>Change Order 8 Amount:</u>	<u>\$ 4,231.40</u>								
Contract Max Not to Exceed Amount:	\$ 69,102,661.19								
Project Schedule									
Adjustment to Schedule	No change								
Signatures									
ACCEPTED:  Webber, LLC	Signature:  Josh Goyne, Vice President – North Texas Date: <u>5/16/2017</u>								
APPROVED:  NET RMA	Signature:  Chris Miller, Director Date: <u>6-13-17</u>								